

FLUKE®

# CNX a3000

## Wireless AC Clamp

### Quick Reference Guide

⚠ Warning

To prevent possible electrical shock, fire, or personal injury, read the "CNX a3000 Safety Information" before you use this Product.

Go to [www.fluke.com](http://www.fluke.com) to register your product and find more information.

#### Amps

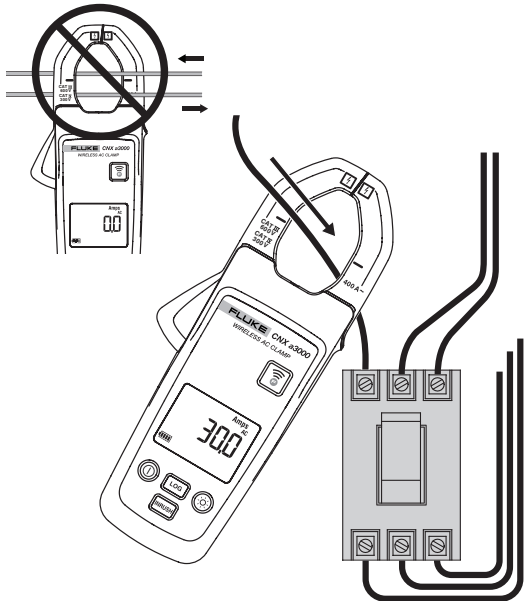

①

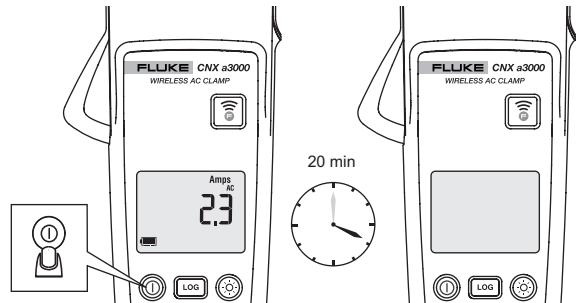

1 OFF	2 LOG + ①	3 LOG x2	4 Poff
5 ☀	6 Amps AC 2.3 ∞	7 ☀	8 Amps AC 2.3 ∞

☀

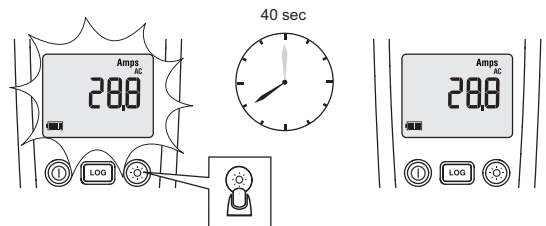

1 OFF	2 LOG + ①	3 LOG x3	4 Loff
5 ☀	6 Amps AC 28.8 ∞	7 ☀	8 Amps AC 28.8 ∞

# INRUSH

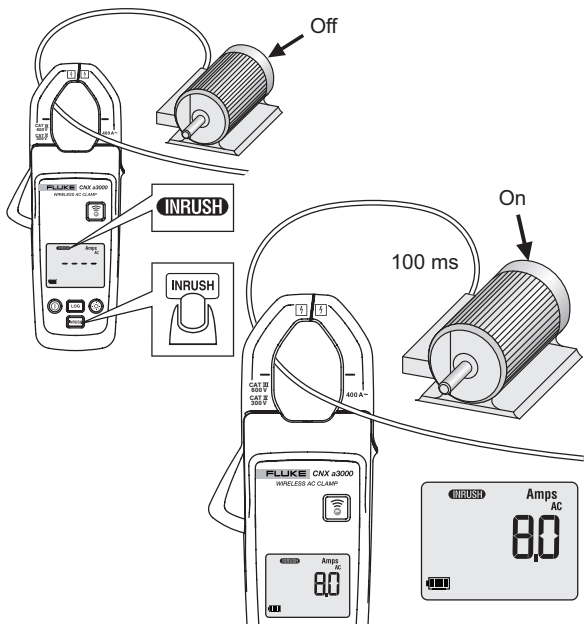

# LOG

