

# CNX v3000

## Wireless AC Voltage

### Quick Reference Guide

#### ⚠️ ⚠️ Warning

To prevent possible electrical shock, fire, or personal injury, read the “CNX v3000 Safety Information” before you use this Product.

Go to [www.fluke.com](http://www.fluke.com) to register your product and find more information.

### Volts AC

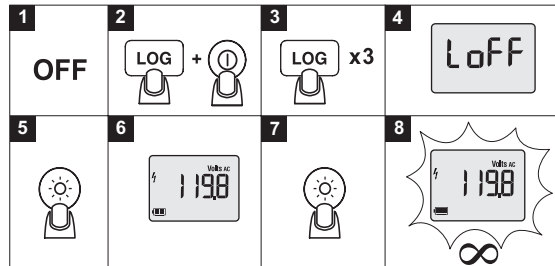
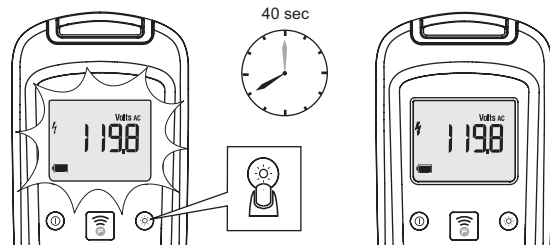
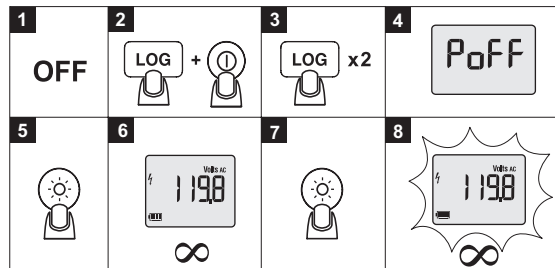
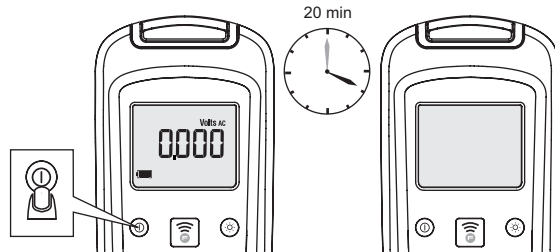
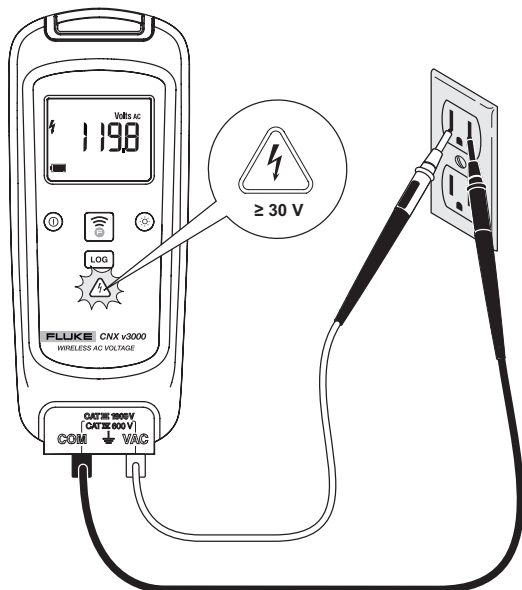

# ToolPak

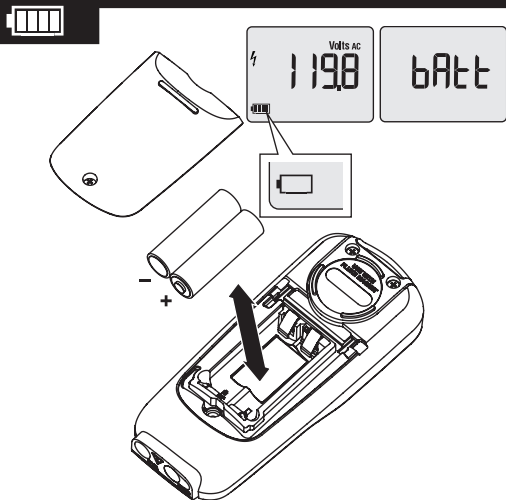
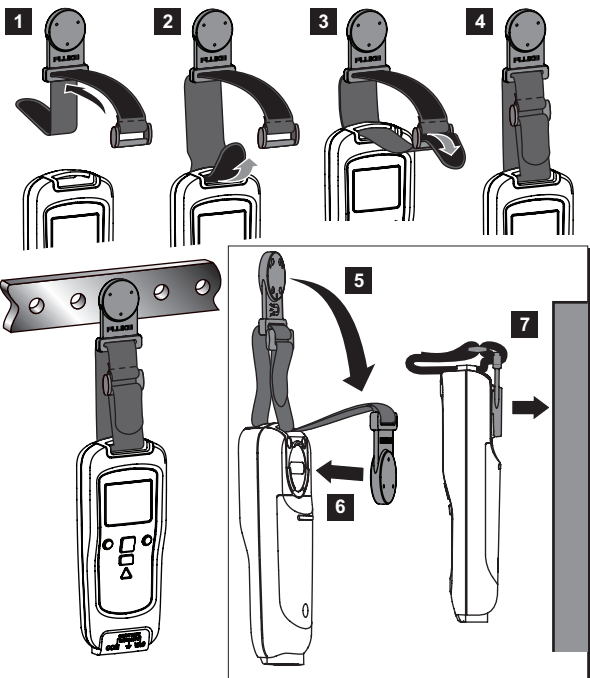

# LOG

