

## Foodpro

### 食品安全型红外温度计

## User Guide

### 使用手册

Fluke Corporation  
P.O. Box 9090  
Everett, WA  
98206-9090

Fluke Europe B.V.  
P.O. Box 1186  
5602 BD Eindhoven  
The Netherlands

MC  
沪制01120009号



PN 2514848 Rev. 2, 11/11

© 2008-2011

All rights reserved. Printed in China.  
Made in China.

上海世禄仪器有限公司  
上海市虹梅南路2638弄139号  
电话：021-54401908

Tous droits ont réservés. Fait dans la Chine. Imprimé dans la Chine.  
Bien reservado. Hecho en la China. Impreso en la China.  
www.fluke.com

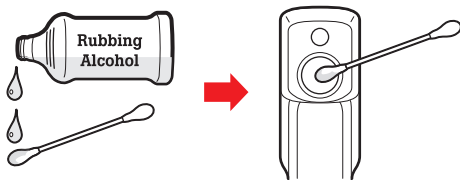
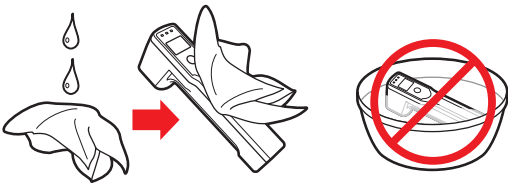
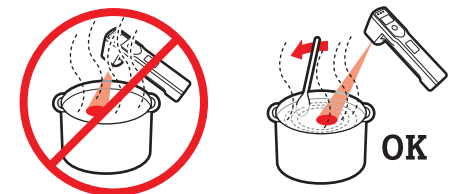
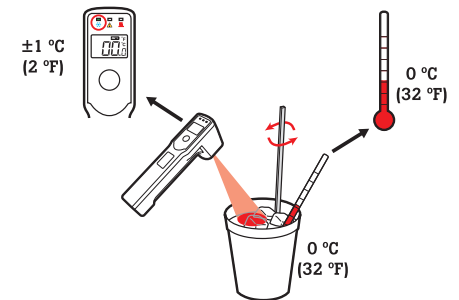
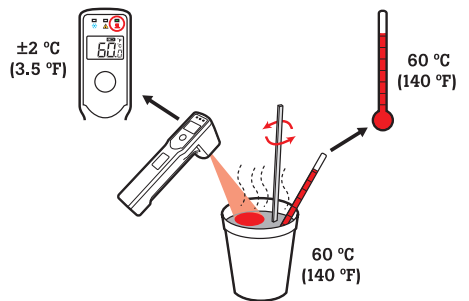
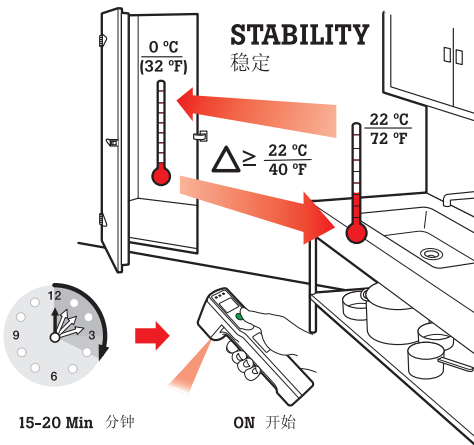

| Temperature Range  | Temperaturbereich  | Etendue de mesure                                    | Range de Temperatura   | Rango de Temperatura  | 測定温度範囲               | -30 °C to 200 °C<br>(-20 °F to 390 °F)  | 温度范围                              | -30 °C ~ 200 °C (-20 °F ~ 390 °F)  |
|--|--|--|--|---|----------------------|---|-----------------------------------|--|
| Accuracy<br>Assumes ambient operating temperature of 23 °C ± 2 °C (73 °F ± 4 °F) | Genauigkeit bei einer Umgebungs-temperatur von 23 °C ± 2 K | Précision par 23 °C ± 2 K ambient                    | Precisão Assume a temperatura operacional ambiente e 23 °C ± 2 °C (73 °F ± 4 °F) | Precisión Suponiendo Temperatura Ambiente de Operación de 23 °C ± 2 °C (73 °F ± 4 °F) | 測定精度 (23°C ± 2°C の値) | Between 0 °C and 65 °C (32 °F to 150 °F): ±1 °C (±2 °F)<br>Below 0 °C (32 °F): ±1 °C (±2 °F) ± 0.1 °<br>Above 65 °C (150 °F): ±1.5 % of reading | 精度<br>环境为 23°C ± 2°C 或 73°F ± 4°F | 0 °C ~ 65 °C (32 °F ~ 150 °F): ±1 °C (±2 °F)<br>低于 0 °C (32 °F): ±1 °C (±2 °F) ± 0.1 度/度<br>高于 65 °C: 读数的 ±1.5 % |
| Response Time  | Ansprechzeit   | Temps de réponse                                     | Tempo de Resposta  | Tiempo de Respuesta   | 応答速度                 | <500 ms after initial reading   | 响应时间                              | <500ms, 在初始读数后   |
| Spectral Response  | Spektrale Empfindlichkeit                                  | Réponse spectrale                                    | Resposta Espectral   | Respuesta Espectral   | 応答波長                 | 8-14 microns  | 响应波长                              | 8-14um   |
| Emissivity   | Emissionsgrad  | Emissivité   | Emissividade   | Emisividad  | 放射率補正                | Pre-set for Food Service Applications   | 发射率                               | 为食品应用预设  |
| Optical Resolution (D:S)   | Optische Auflösung (E:M)                                   | Résolution optique (E:S)                             | Resolução Óptica (D:S)   | Resolución Óptica (D:S)   | D:S比                 | 2.5:1 @ 90% energy, typical   | 光学分辨率 (D:S)                       | 2.5:1 (90%能量, 典型值)   |
| Typical Working Range (target illumination)                                      | Typische Messentfernung (Messfleckbeleuchtung)             | Distance de mesure classique (Eclairage de la cible) | Range de Operação Típica (iluminação do alvo)                                    | Rango típico de Aplicación (iluminación del objetivo)                                 | 標準測定距離               | ≈25 mm to 250 mm (=1 in to 10 in)   | 典型的工作范围 (目标照明)                    | 约从 25mm 到 250mm  |
| Repeatability  | Reproduzierbarkeit   | Reproductibilité                                     | Repetibilidade   | Repetibilidad   | 反復精度                 | Within accuracy specifications of the unit  | 重复性                               | 小于最大误差   |
| Ambient Operating Range  | Umgebungs-temperaturbereich                                | Température ambiante                                 | Range Operacional do Ambiente  | Temperatura Ambiente de Operación   | 動作環境溫度               | 0 °C to 50 °C (32 °F to 122 °F)   | 操作环境温度范围                          | 0 °C ~ 50 °C (32 °F ~ 122 °F)  |
| Relative Humidity  | Relative Luftfeuchte                                       | Humidité relative                                    | Umidade Relativa   | Humedad Relativa  | 相对湿度                 | 10-90 % RH noncondensing, @ up to 30 °C (86 °F)   | 相应湿度                              | 10~90%, 在 30°C, 无凝露  |
| Storage Temperature  | Lagertemperatur  | Température de stockage                              | Temperatura de Armazenamento   | Temperatura de Almacenamiento   | 保存溫度                 | -20 °C to 60 °C (-4 °F to 140 °F)   | 儲存溫度                              | -20 °C ~ 60 °C (-4 °F ~ 140 °F)  |
| Weight/Dimensions (with battery)   | Abmessungen (inklusive Batterien)                          | Dimensions Masse (avec les piles)                    | Peso/Dimensões (com bateria)   | Peso/Dimensiones (con bateria)  | 重量/寸法                | 150 mm x 30 mm x 50 mm (5.88 in x 1.25 in x 2 in)<br>150 g (0.33 lbs)   | 重量/尺寸带 (电池)                       | 150mmX30mmX50mm, 150 克   |
| Power  | Spannungsversorgung  | Alimentation   | Alimentação  | Alimentación  | 電源                   | 1 AA alkaline battery   | 电源                                | 一节五号 AA 电池   |
| Battery Life   | Batterielebensdauer  | Autonomie des piles                                  | Durabilidade da Bateria  | Duración de la Bateria  | 電池驅動時間               | 10 hours minimum @ 23 °C (73 °F)  | 電池壽命                              | 在 23 °C (73 °F) 时, 至少 10 小时  |
| Display Resolution   | Anzeigenaufösung   | Résolution d'indication de température               | Resolução do Display   | Resolución en Pantalla  | 表示分辨率                | 4 digits, 0.1 °C (0.2 °F)   | 显示分辨率                             | 4 位, 0.2 °C (0.5 °F)   |
| Display Hold   | Anzeigenhaltezeit  | Durée d'affichage                                    | Espera do Display  | Retención de Lectura  | ホールド時間               | 7 sec   | 显示保持                              | 7 秒  |
| Standards  | Standards  | Standards  | Padrões  | Estándares  | 適合規格                 | Conforms to:<br>• EN61326-1 Electromagnetic Emissions and Susceptibility, Criteria B<br>• EN61010-1 General Safety                              | 标准                                | 符合:<br>EN61326-1 电磁辐射和响应标准<br>EN61010-1 通用安全标准   |
| Environmental Sealing  | Schutzgrad   | Degré de protection                                  | Vedação Ambiental  | Sellado Ambiental   | 保護等級                 | IP54 Sealing (hand washable, non submersible)   | 环境密封                              | IP54, (可以手擦洗, 不能浸液)  |
| Minimum Target Size  | Kleinste Messfleckgröße                                    | Taille minimale du spot                              | Tamanho Mínimo do Alvo   | Tamaño Mínimo de Objetivo   | 最小目標尺寸               | ≈12 mm (≈0.5 in)  | 最小目标尺寸                            | 约 12mm   |
| Illumination to IR Channel Offset  | Offset: Messkanal zu Beleuchtung                           | Offset: canal infrarouge pour éclairage              | Iluminação para o Deslocamento (Offset) do Canal IV                              | Desalineación Entre Canales de Iluminación e Infrarrojo                               | 照準中心軸オフセット           | 13 mm (0.52 in)   | 照明与 IR 的偏差                        | 13mm   |
| Certifications   | Zertifizierung   | Certification  | Certificado  | Certificacaciones   | 認證                   | CE NSF  | 认证                                | CE NSF CMC   |

# HACCP ✓

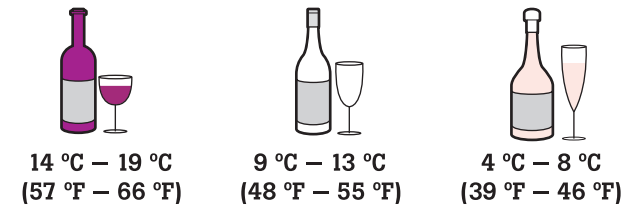
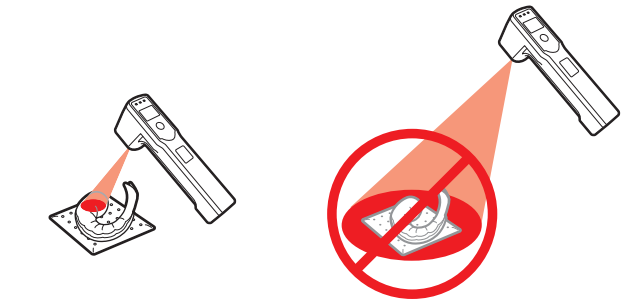
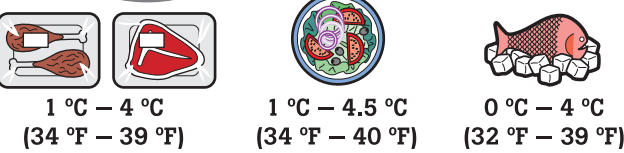
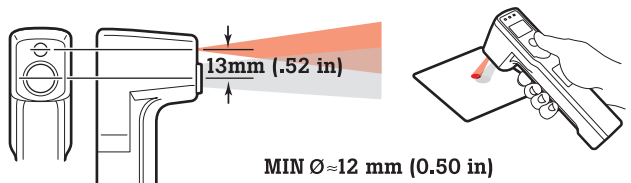
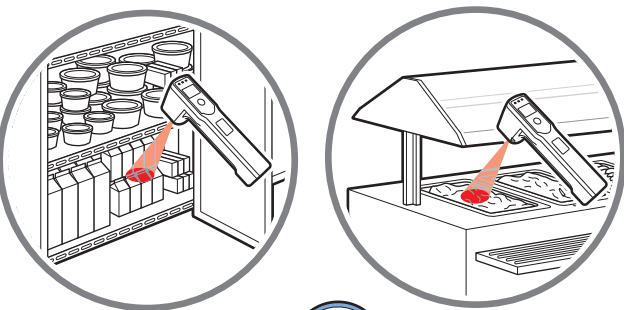
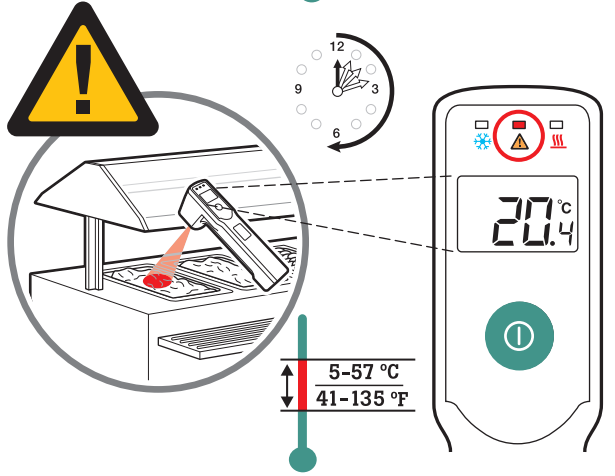
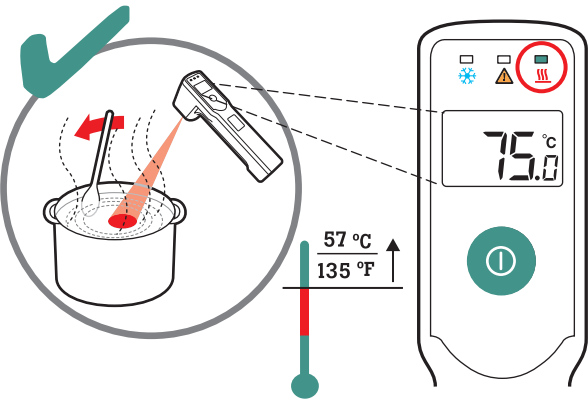
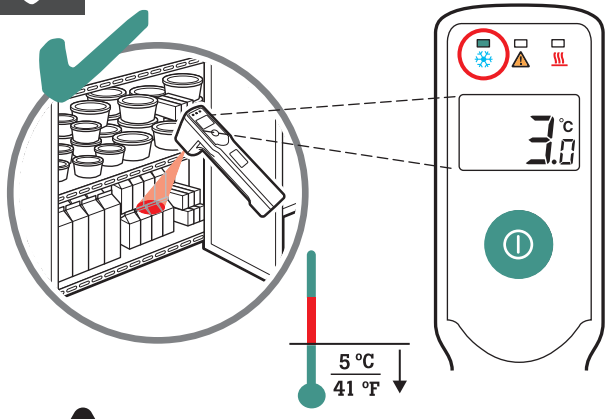
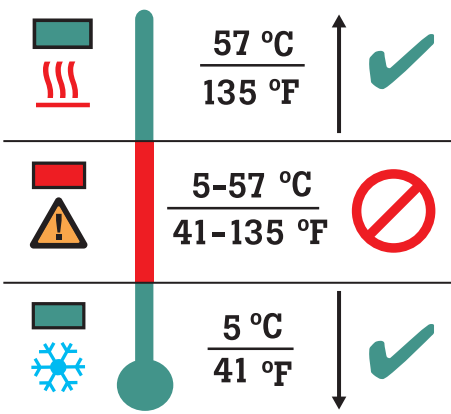

MIN 最小

MAX 最大

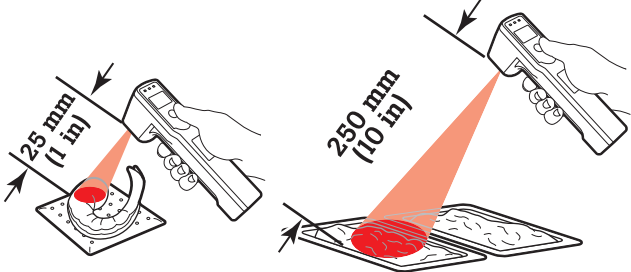
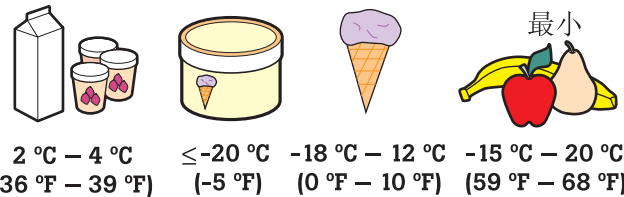

HACCP Zone Indicators / Indicateur zone HACCP  
 HACCP-Bereichsanzeige / Indicadores de Zona APPCC HACCP  
 HACCP ゾーン表示 / HACCP 区域指示灯

C°/F° Indicator / Affichage C°/F°  
 C°/F°-Anzeige / Indicador C°/F°  
 Indicador C°/F° / 温度表示 (C°)  
 C°/F° 指示灯

Low Battery Icon / Icône Etat des piles  
 Batteriezustandsanzeige / Icono de Bateria  
 Baja / Ícone de bateria com carga baixa  
 バッテリーアイコン 電池电量不足 图标

ON (Measure) / ON (Mesure) / ON (Messen)  
 ON (Medición / ON (Medida)  
 ON 测温 ボタン / ON (测量)

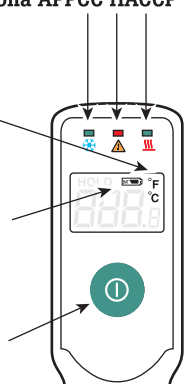

Target Illumination / Eclairage de la cible Optique  
 Messfleckbeleuchtung / Iluminación del Objeto  
 Iluminação alvo / マーカー (照準) / 目标照明

Window for IR Optics / Sonde  
 Infraoptique / Ventana de Óptica IR  
 Janela para óticos IR  
 红外测  
 量窗口  
 レンズ

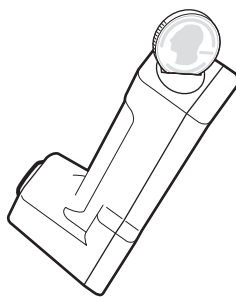
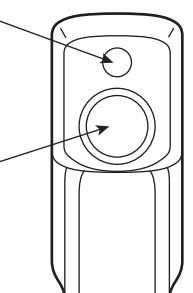

Battery Type  
 AA ANSI/NEDA  
 标准AA电池

