

## Press-in socket EB4-A...

Insulated, Ø 4 mm, rigid. Machined brass.  
The socket is pressed into predrilled panels of plastic, metal etc. Nickel-plated and gold-plated versions available.

**Round connecting pin Ø 1.9 mm.**

EB4-A



EB4-A/N

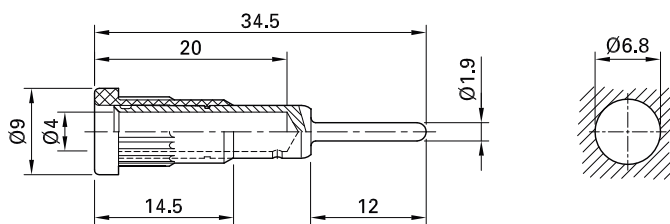

Order No.	Type	Rated voltage/current		*Standard colors										
23.1014-*	EB4-A	30 VAC / 25 A 60 VDC / 25 A	Au	<table border="1"> <tr> <td>20</td> <td>21</td> <td>22</td> <td>23</td> <td>24</td> </tr> <tr> <td>25</td> <td>26</td> <td>27</td> <td>28</td> <td>29</td> </tr> </table>	20	21	22	23	24	25	26	27	28	29
20	21	22	23	24										
25	26	27	28	29										
49.7077-*	EB4-A/N	30 VAC / 25 A 60 VDC / 25 A	Ni	<table border="1"> <tr> <td>21</td> <td>22</td> <td>23</td> <td>24</td> <td>25</td> </tr> <tr> <td>26</td> <td>27</td> <td>28</td> <td>29</td> <td></td> </tr> </table>	21	22	23	24	25	26	27	28	29	
21	22	23	24	25										
26	27	28	29											

### Component parts

23.5013-*	I-EB4	Insulator
23.5014	B-EB4-A	Socket for EB4-A
23.5025	B-EB4-A/N	Socket for EB4-A/N



Optional colors 20

Further information, page 6



Press-in tool MB4, page 171



Assembly instructions MA103

[www.staubli.com/electrical](http://www.staubli.com/electrical)