

## Press-in socket EB4-C

Insulated, Ø 4 mm, rigid. Machined brass.  
The socket is pressed into predrilled panels of plastic, metal etc.

**Round connecting pin Ø 1.2 mm.**

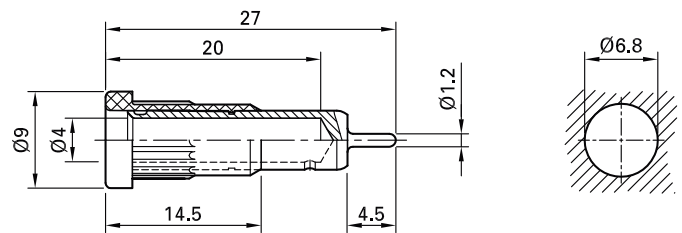

Order No.	Type	Rated voltage/current		*Standard colors										
23.1016-*	EB4-C	30 VAC / 25 A 60 VDC / 25 A	Au	<table border="1"> <tr> <td>20</td> <td>21</td> <td>22</td> <td>23</td> <td>24</td> </tr> <tr> <td>25</td> <td>26</td> <td>27</td> <td>28</td> <td>29</td> </tr> </table>	20	21	22	23	24	25	26	27	28	29
20	21	22	23	24										
25	26	27	28	29										

### Component parts

23.5013-*	I-EB4	Insulator
23.5308	B-EB4-C	Socket



Press-in tool MB4, page 171



Assembly instructions MA103

[www.staubli.com/electrical](http://www.staubli.com/electrical)